

Crown (A) is unscrewed and pulled one “click” out

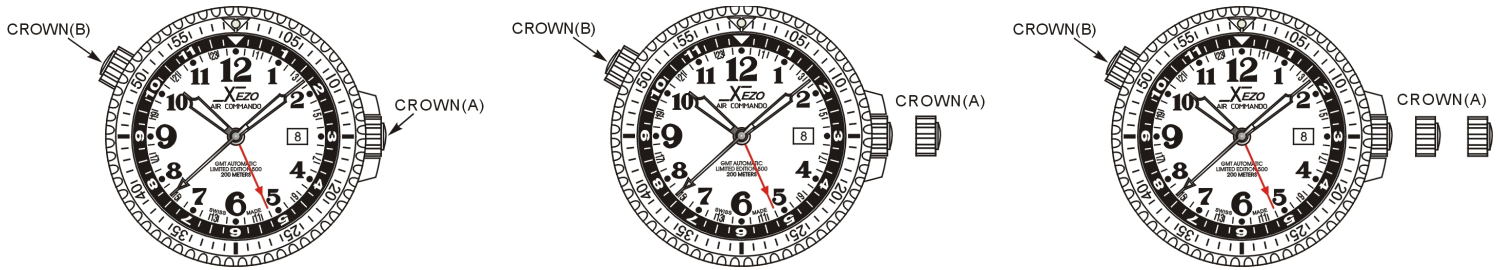

Thank you for choosing a time-piece from our collection.
The Xezo Air Commando Limited Edition 500 sports 2 screw-down crowns.
Crown (A) at 3 o'clock is used to adjust local time, 2nd time zone (movement caliber 2893-2) and date.
Crown (B) at 10 o'clock operates the inner rotating bezel.
Both crowns are screw-down locked crowns.

Your watch is fitted with Swiss-made ETA automatic movement (calibers 2893-2, 2892A2, 2836-2, and 2824-2). The inner mechanism of the watch has a free swinging rotor that keeps the mainspring wound via the motion of your wrist. A watch fitted with an automatic winding movement is rewound by the regular movements of your wrist. *Once fully wound, your watch will continue to keep time for approximately 42 hours (calibers 2893-2 and 2892A2) after removing it from your wrist. Beyond this time, the watch will stop. You will then need to rewind it manually by unlocking the crown (A), and then turning the crown (A) clockwise (approximately 20 turns) to provide it with the necessary power reserve. After that, your daily activity should wind the watch sufficiently to keep it running at night when it is not being worn. You should wear your watch everyday to ensure optimal rewinding.*

Important note: To unlock the screw-down crown (A) turn it 10-12 times counter-clockwise.

Note: As this is a mechanical watch, quartz watch accuracy cannot be expected.

We recommend self-adjustment exercise before setting the time and date.

Unlock the screw-down crown (A) by turning it 10-12 times counter-clockwise. Pull out the crown (A) to Position “3” (two “clicks” out). The seconds hand is stopped. Turn the crown clockwise and counter-clockwise, to let the hour hand and the minute hand do "exercise" or "self-adjustment". For example set hour and minute hands at 6:30PM and then 5:30PM. Then, set hour and minute hands at 6:00PM. You should notice that the GMT hand (24-hour red color hand for caliber 2893-2) now points to one of the 24 "hour" markers on the dial.

Once you have performed self-adjustment exercise, return the screw-down crown (A) to the locked position by pressing it against the case and turning it clockwise. Screw-down crown (A) now should be screwed down tightly to Position “1”.

Setting the Time and Date (movement calibers 2893-2, 2892A2, 2824-2)

Important note: Do not change the date between 8 p.m. and 2 a.m. as this may damage the movement. This is when the pinions are being repositioned to carry out the automatic date change.

1.

Unlock the screw-down crown (A) by turning it 10-12 times counter-clockwise. Pull out the crown (A) to Position “2” (one “click” out). Rotate the crown (A) counter-clockwise until the date shows one day earlier than the date you want to set. Pull out the crown (A) to Position “3” (two “clicks” out). The seconds hand is stopped. Set the local time by turning the crown (A) counter-clockwise to move the hour and minute hands forward. Turn the watch hands past 12 once if you’re setting the watch for a P.M. time.

Setting the Time, Day and Date (movement caliber 2836-2)

Important note: Do not change the date between 8 p.m. and 2 a.m. as this may damage the movement.

1.

Unlock the screw-down crown (A) by turning it 10-12 times counter-clockwise. Pull out the crown (A) to Position “2” (one “click” out). Rotate the crown (A) clockwise until the date shows one day earlier than the date you want to set. Rotate the crown (A) counter-clockwise until the day shows one day earlier than the day you want to set. Pull out the crown (A) to Position “3” (two “clicks” out). The seconds hand is stopped. Set the local time by turning the crown (A) counter-clockwise to move the hour and minute hands forward. Turn the watch hands past 12 once if you’re setting the watch for a P.M. time.

2.

Once you have set the time or date, return the screw-down crown (A) to the locked position by pressing it against the case and turning it clockwise. Screw-down crown (A) now should be screwed down tightly to Position “1”.

Remark:

You can synchronize the seconds hand with an official time signal (radio/ TV/Internet). When the crown (A) is pulled out in Position “3” (two “clicks” out), the seconds hand is stopped. As soon as the time setting has been synchronized, return the screw-down crown (A) to the locked position by pressing it against the case and turning it clockwise. Screw-down crown (A) now should be screwed down tightly to Position “1”.

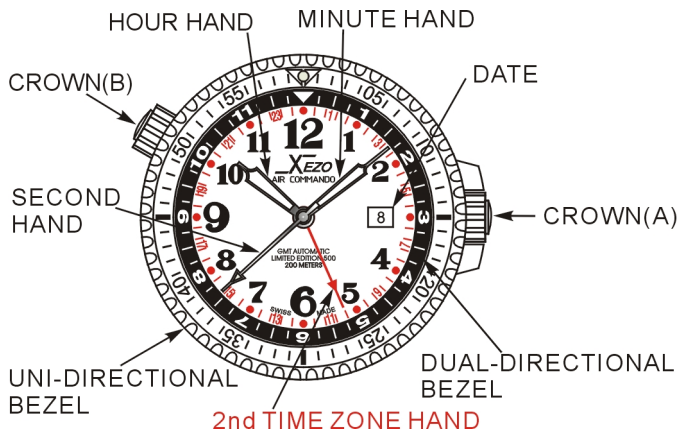

2nd Time Zone Feature (for movement caliber 2893-2)

Note: The second time zone is read in military time (1:00 p.m. = “13”, 2:00 p.m. = “14”, etc.). The military time hours appear in red color on the dial.

1.

Begin by setting the regular time by following self-adjustment exercise and the instructions for Setting the Time and Date.

2.

To set the second time zone, unscrew the crown (A). Pull out the crown (A) to Position “2” (one “click” out) and set the second time zone hand (indicated above in red color) by turning the crown clockwise.

3.

Once you have set the second time zone, return the screw-down crown (A) to the locked position by pressing it against the case and turning it clockwise. Screw-down crown (A) now should be screwed down tightly to Position “1”.

Using the rotating uni-directional bezel

This feature enables you to track elapsed time.

1.

Turn the bezel counter-clockwise until the zero mark is at the minute hand.

Important note: This model has unidirectional rotating bezel; the bezel only turns counter-clockwise to assure that if moved unintentionally, the time reading will err on the side of caution when measuring elapsed time.

2.

The position of the minute hand in relation to the zero mark on the bezel will indicate the total number of minutes elapsed.

Using dual-directional inner rotating bezel to track elapsed time (for Air Commando and Air Commando R models)

This feature enables you to track elapsed time in hours.

Hold the watch face-up with the numeral 6 pointing toward you and the calendar on your right. Then rotate the watch 180 degrees counterclockwise. (Numeral 12 now points toward you.)

Hold the crown (B) with the thumb and index finger of your right hand.

To unlock the inner bezel, turn the crown (B) 4 or 5 times counterclockwise.

Turn the inner bezel in either direction until the triangle on it points to the hour hand.

Once you have set the inner bezel, return the screw-down crown (B) to the locked position by pressing it against the case and turning it clockwise.

The crown (B) should now be screwed down tightly.

Using dual-directional inner rotating bezel as additional time zone or to track elapsed time (for Air Commando R44 model)

This feature enables you to set the additional time zone or to track elapsed time. Hold the watch face-up with the numeral 6 pointing toward you and the calendar on your right. Then rotate the watch 180 degrees counterclockwise. (Numeral 12 now points toward you.)

Hold the crown (B) with the thumb and index finger of your right hand.

To unlock the inner bezel, turn the crown (B) 4 or 5 times counterclockwise.

To set the additional time zone turn the inner bezel in either direction until the 24-hour hand points to the desired marker on the 24-hour scale of the inner rotating bezel.

To track elapsed time turn the inner bezel in either direction until the triangle on it points to the 24-hour hand.

Once you have set the inner bezel, return the screw-down crown (B) to the locked position by pressing it against the case and turning it clockwise.

The crown (B) should now be screwed down tightly.

Using dual-directional inner rotating bezel as additional time zone or to track elapsed time (for Air Commando D44 model)

This feature enables you to set the additional time zone or to track elapsed time. Hold the watch face-up with the numeral 6 pointing toward you and the calendar on your right. Then rotate the watch 180 degrees counterclockwise. (Numeral 12 now points toward you.)

Hold the crown (B) with the thumb and index finger of your right hand.

To unlock the inner bezel, turn the crown (B) 4 or 5 times counterclockwise.

To set the additional time zone turn the inner bezel in either direction until the hour hand points to the desired marker on the 24-hour scale of the inner rotating bezel.

To track elapsed time turn the inner bezel in either direction until the triangle on it points to the hour hand.

Once you have set the inner bezel, return the screw-down crown (B) to the locked position by pressing it against the case and turning it clockwise.

The crown (B) should now be screwed down tightly.

Important Note:

In order to insure that your watch remains water-resistant, it is important that crown (A) and crown (B) are always returned to the locked position.

Specifications:

Case and Bracelet – 316L Stainless Steel (leather band is optional)

Glass – Flat Sapphire Crystal

Movement – Swiss-made ETA automatic (cal. 2893-2, 2892A2, 2836-2, 2824-2)

Case back – Sapphire Crystal Glass

Water-Resistance – 200M/660FT

Power reserve:

Cal. 2893-2, 2892A2 - 42 hours

Cal. 2836-2, 2824-2 - 38 hours

Servicing your Xezo Automatic watch

Although components in your watch have been manufactured from first-rate materials, certain parts are subject to natural wear and tear. It is vital that all moving parts are properly lubricated at all times and that the watch is cleaned at regular intervals to remove dirty oil.

We therefore, recommend that you have your watch serviced about once every 3-5 years. Contact us for after-sales service.

<http://www.xezo.com>